

X:\3920000.all\3924100\Drawings\Maps\Town of Mead\Comp Plan Maps\Mead Comp Plan Maps\Map 9-27-04.dwg, WATERSHEDS, 09/23/2004 10:48:09 AM, fortunet

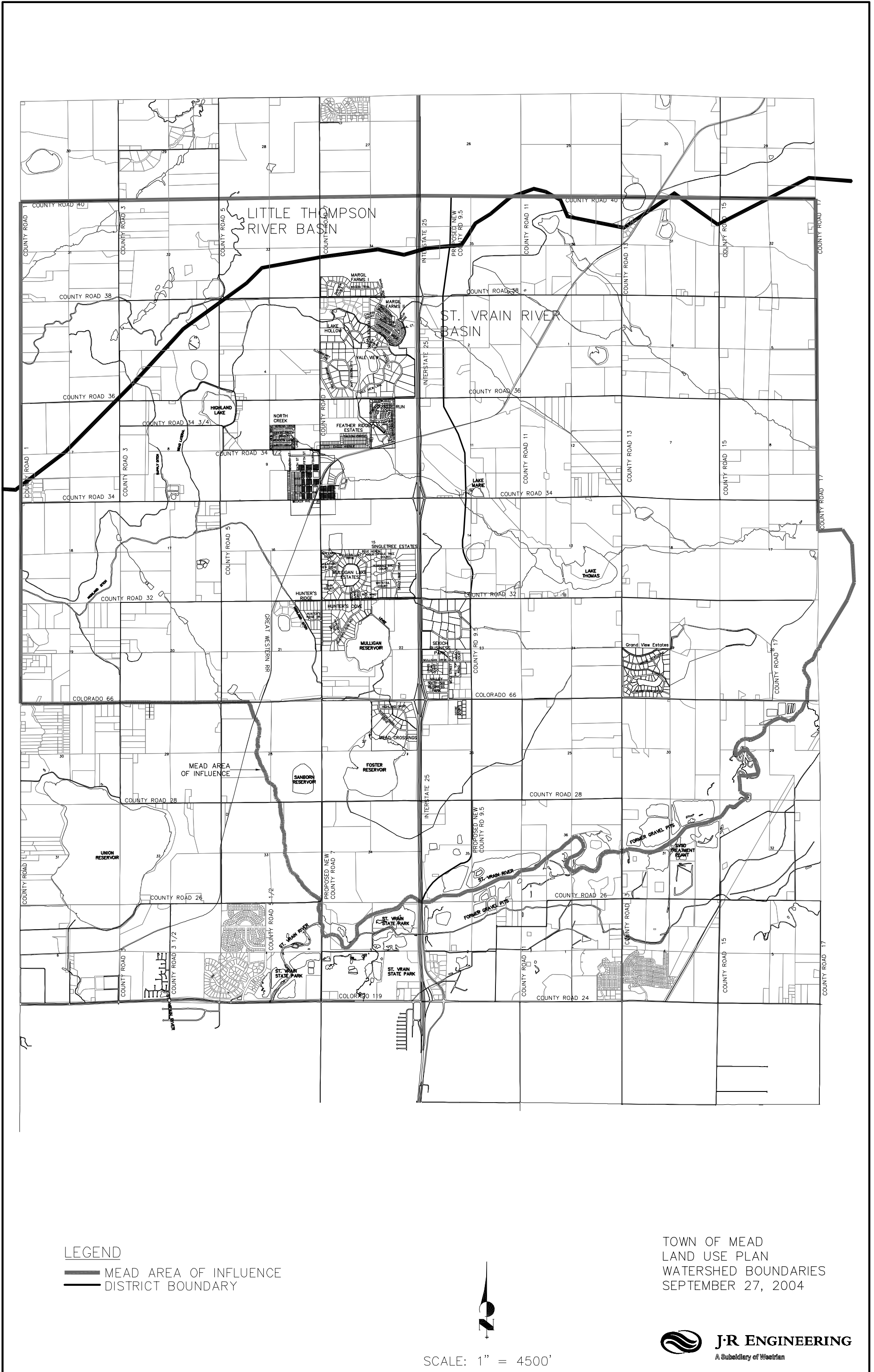

LEGEND

- MEAD AREA OF INFLUENCE
- DISTRICT BOUNDARY



SCALE: 1" = 4500'

TOWN OF MEAD
LAND USE PLAN
WATERSHED BOUNDARIES
SEPTEMBER 27, 2004



2620 East Prospect Road, Suite 190 • Fort Collins, CO 80525
970-491-9888 • Fax: 970-491-9984 • www.jrengineering.com