

ALL DRIVEWAYS TO REMAIN OPEN UNLESS OTHERWISE INDICATED.

FLAGGERS TO ASSIST WITH PEDESTRIAN TRAFFIC.

POST TEMPORARY "NO PARKING" IN ALL AREAS AFFECTED BY THE WORK AREA 72 HRS PRIOR TO WORK. NOTIFY ALL AFFECTED BUSINESSES/RESIDENTS.

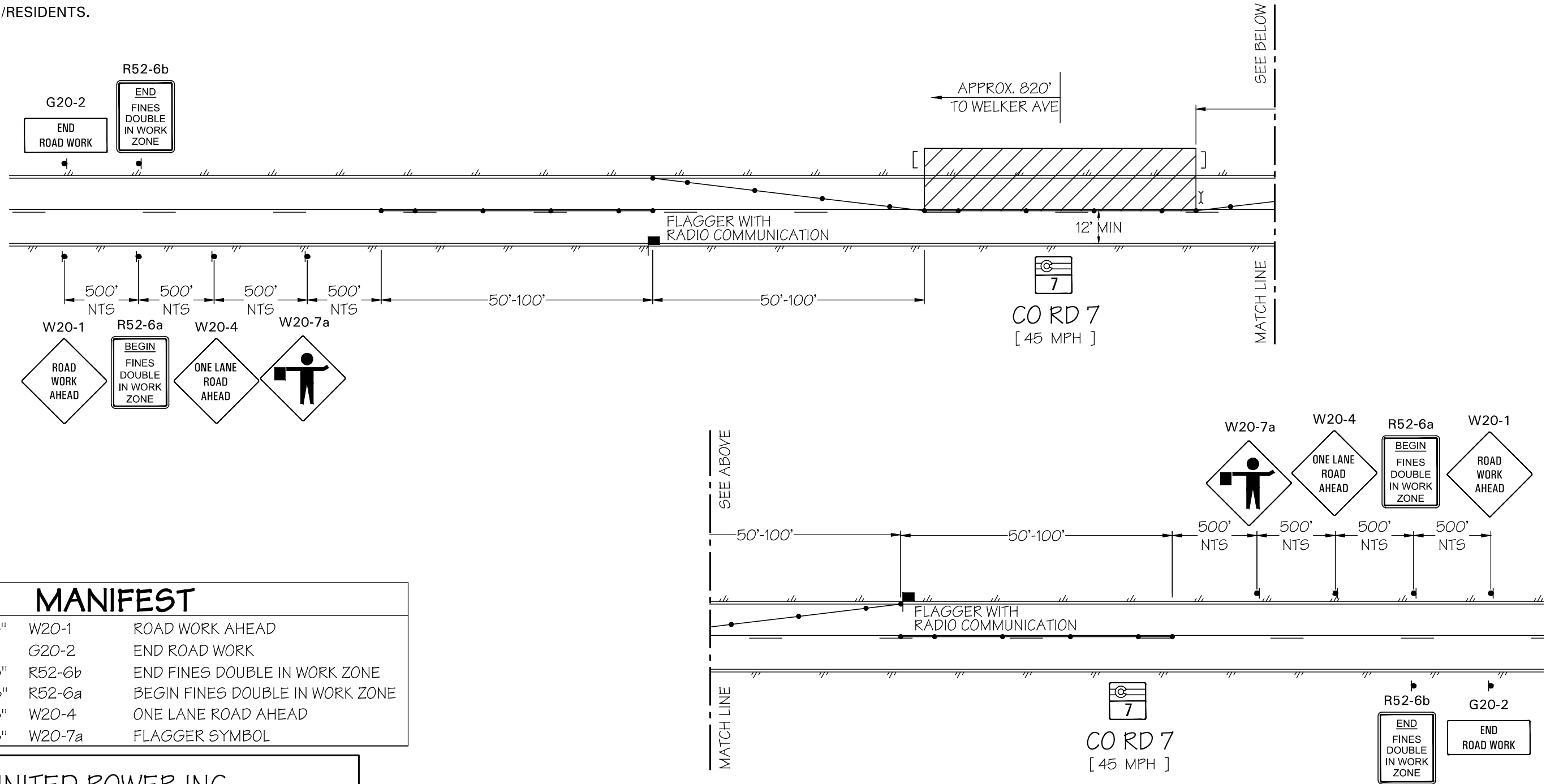

### MANIFEST

2 x	48"x48"	W20-1	ROAD WORK AHEAD
2 x	36"x18"	G20-2	END ROAD WORK
2 x	36"x48"	R52-6b	END FINES DOUBLE IN WORK ZONE
2 x	36"x48"	R52-6a	BEGIN FINES DOUBLE IN WORK ZONE
2 x	48"x48"	W20-4	ONE LANE ROAD AHEAD
2 x	48"x48"	W20-7a	FLAGGER SYMBOL

### UNITED POWER INC.

#### LEGEND

- WORK AREA	- TYPE-III BARRICADE W/ SIGN
- HIGH LEVEL WARNING DEVICE	- TYPE-II BARRICADE W/ SIGN
- FLASHING ARROW SIGN (FAS)	- ADA BARRICADE W/ SIGN
- FLAGGER	- CHANNELIZATION DEVICE
- EXISTING SIGN	- SIGN

#### ADDRESS

15841 WELD COUNTY RD 7,  
MEAD

WORK AREA TRAFFIC CONTROL: 15841 WELD COUNTY RD 7

CONTACT: ADAM DILLON

CONTACT: (303) 637-1282

JOB NUMBER: 478401

PLAN#: 89557

WO#: 202404023

SHEET 1 OF 1 SIZE: B

SCALE: 1"=40'

DATE: 04/17/24

PREPARED BY: DAY

### TRAFFIC MANAGEMENT, INC.

California · Great Lakes · New York

800.763.3999

www.trafficmanagement.com

Traffic Control Services · Sales & Rentals

Permits & Consulting · Engineering · Training

C31 # 785804

